

## Instructions for use

2021-03-15

### CuroCell® AUTO420

Automatic active air mattress system

Instructions for use item number: 95-001617



7 331345 047959



# Table of contents

WARNINGS AND SAFETY PRECAUTIONS	3
1. Introduction	5
2. Product description	6
3. Assembly/Installation	9
4. Operation	10
5. Reuse, cleaning and reconditioning	12
6. Storage	14
7. Maintenance	14
8. Troubleshooting	15
9. Technical description	16
10. Spare parts	18
11. Options and accessories	19
12. Warranty	20
13. Other information	21
14. Notes	22

# WARNINGS AND SAFETY PRECAUTIONS

Read all instructions prior to use

**WARNING! To minimize the risk of fire, personal injury and equipment/property damage adhere to the following instructions:**

1. The product must only be installed and used for its intended purpose according to the instructions in this manual and/ or other documentation from Care of Sweden. The product must not be combined, assembled or repaired with parts (e.g. pump and mattress), accessories or spare parts other than those described in this manual or other documentation from Care of Sweden. The product must not be modified in any way.
2. The product must be placed and used so that it does not become trapped or damaged. Note: Be particularly aware of trapping damage when using side rails. Always make sure that the mattress is the correct size for the bed.
3. Regularly check product functionality by performing a hand check (see section 4.4).
4. When the product is used for individuals needing special supervision, such as children, continuous monitoring is required.
5. The mattress is protected by a hygiene cover; avoid using multiple hygiene covers as this can affect the vapor permeability of the mattress.
6. The hygiene cover does not allow liquid or air to penetrate, but is vapour permeable. Make sure that the user is positioned correctly to avoid the risk of suffocation.
7. Be careful with sharp objects to prevent damage to the hygiene cover.
8. Do not open the pump housing – risk for electric shock. Servicing and maintenance must be performed by Care of Sweden or one of its authorized service technicians.
9. Route the power cable to the pump carefully to avoid tripping. Also make sure that the user is lying correctly on the mattress according to the instructions and use a cable holder if possible.
10. To avoid the risk of strangulation, make sure that the cable and tubes are routed to prevent someone getting caught up in them.

**Note: The responsible healthcare provider must inform the user/operator of the following:**

11. Do not use the product in bathrooms or other area where there is a risk of the pump coming into contact with water or other liquids. Except for specified cleaning, never handle a product that has come into contact with water/liquid. Pull the plug out of the electrical socket immediately and send the product to an authorized service technician for servicing
12. Do not use close to or in contact with fire sources/hot surfaces, such as fire, burning cigarettes, hot lamps, heating fans or heating stoves/open fires as this could damage the product.
13. Do not store or use the product in direct sunlight. The product may be damaged by the elevated temperature and UV light.
14. Strong magnetic fields or wireless communication equipment (e.g. wireless home network products, mobile phones, walkie-talkies, cordless phones and their base stations, radio transmitters, etc.) may affect the product's functionality and should be kept at a distance of at least 1 meter from the pump.
15. Never use the product if the power cable, plug of the pump or power supply housing is defective, if the pump housing is damaged, or if it is not functioning properly. Contact an authorized service technician for examination and repair.
16. Never connect anything other than the Care of Sweden supplied power supply to the pump power cable connector.
17. If the hygiene cover is equipped with side handles, these are intended for managing or relocating the mattress. Do not use the handles to lift the mattress with an user lying on it. All other use takes place under your own liability and is not covered by the product warranty.
18. To prevent the Power supply from being pulled out, exercise caution when there are children and pets in the environment around the equipment.
19. Use of this product adjacent to or stacked with other equipment should be avoided because it could result in improper operation. If such use is necessary, this product and the other equipment should be observed to verify that they are operating normally.
20. In order to minimize the risk of wounds occurring on the feet, make sure that the user doesn't come into contact with the hangers of the pump.

# 1. Introduction

CuroCell® air mattresses work according to the alternating pressure principle, a technique that is thoroughly tried and tested and has been used for a long time. Alternating pressure means that the pressure is alternated regularly between the cells in order to simulate the body's own movements. Periods are created in which the pressure is lower or completely absent. This provides good conditions for the skin to recover and to prevent injury.



Always read the instructions for use prior to use.

For further questions regarding installation, use or maintenance please contact Care of Sweden or your local distributor.

## 1.1 General information

This system is a medical device with CE marking in accordance with Medical Device Regulation (EU) (2017/745).

The system has been fully or partially designed and verified in accordance with the standards listed in section 9.2. Standards.

According to statutory regulations made by the authorities regarding medical devices, the manufacturer is required to report all accidents or incidents involving the products. We would be very grateful for all information involving accidents or incidents relating to our products, by reporting them immediately to us, at Care of Sweden.

## 1.2 Intended use

The system consist of a pump and a mattress and are used for prevention and as an aid in the treatment of pressure ulcers/pressure injuries (PU/PI).

## 1.3 Indications

For users with pressure ulcers/pressure injuries (PU/PI) up to and including category 4 and unclassified PU/PI (unstageable and suspected deep tissue injury<sup>1</sup>). As well as for users in risk of PU/PI.

## 1.4 Contraindications

There are no known contraindications.

## 1.5 User application

The systems can be used in all kinds of health care environments. The mattress is intended to be used for people with a recommended minimum height of 120 cm and a recommended user weight of up to 250 kg. CuroCell® AUTO420 is a replacement mattress placed directly on the bed base.

#### NOTE:

1. For certain users, such as amputees, the recommended height measurement may not be met. Users in these groups may, however, require other settings, as the entire surface is not under load. To check functionality, see sections 4.2, 4.3 and 4.4.
2. When used together with positioning pillows, read the pillow instructions for use carefully for correct positioning of the user.
3. Whenever this product is used with an evacuation sheet, it is the responsibility of the attending personnel to ensure that evacuation can be performed safely.
4. Be careful when using bed rails or other protection on the bed so that the mattress is not pinched or damaged.
5. The mattress must not be lifted with a person lying on it or used for any other type of transport other than necessary evacuation using an evacuation sheet.
6. The mattress is not suitable for use during X-ray examinations. This is because of the risk of image blurring and artefacts that may lead to diagnostic errors.

(1) European Pressure Ulcer Advisory Panel, National Pressure Injury Advisory Panel and Pan Pacific Pressure Injury Alliance. Prevention and Treatment of Pressure Ulcers/Injuries: Clinical Practice Guideline. The International Guideline. Emily Haesler (Ed). EPUAP/NPIAP/PPPIA: 2019

## 1.6 Other information

### Action plan for pressure ulcers/pressure injuries

For the best possible results when using this product, we recommend a structured and planned approach. Examples that can be applied to the use of our products can be found in the “Action plan for pressure ulcers/pressure injuries guidelines.

### The Mattress Guide

This guide provides guidance to personnel and prescribers when choosing a mattress from Care of Sweden. CuroCell® AUTO420 is a mattress in function group C. This information can be obtained from our website, [www.careofsweden.com](http://www.careofsweden.com), or ordered from Customer Service (see contact information on the last page).

## 2. Product description

### 2.1 Pump and mattress

1. Mattress
2. CPR (Rapid deflation)
3. Pump connector
4. Pump

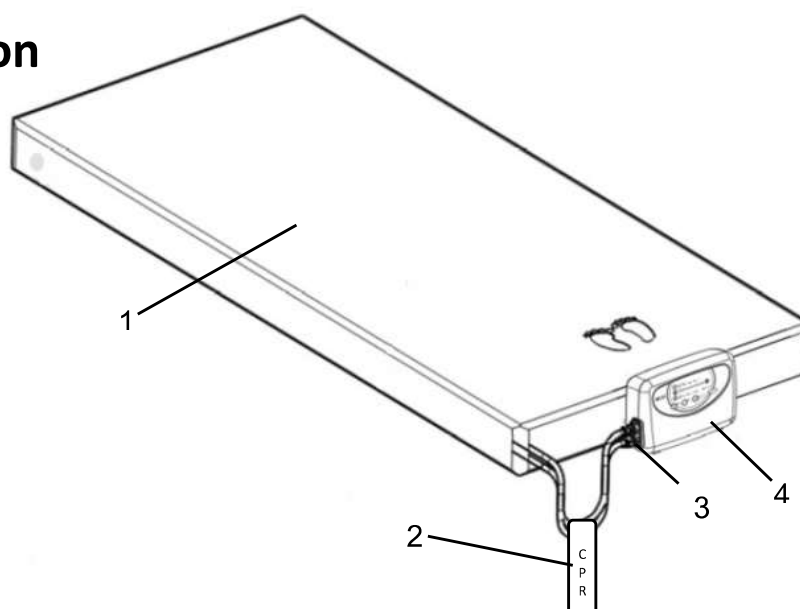

## Mattress (without cover)

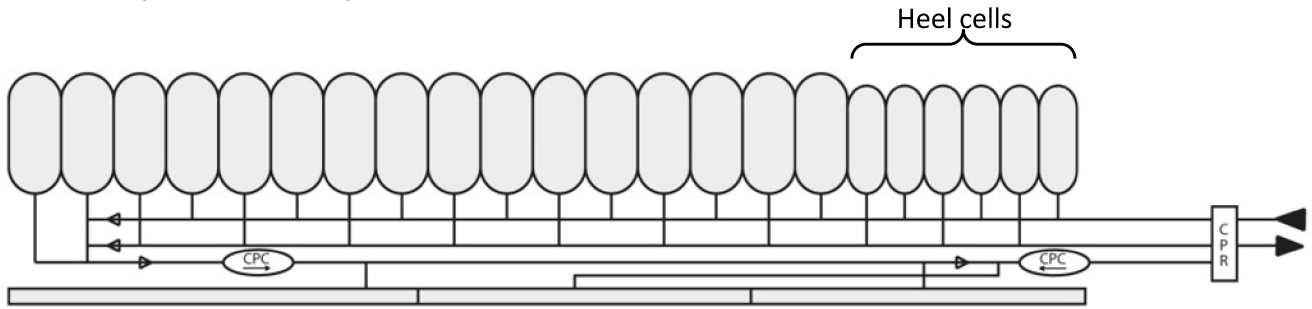

## 2.2 Pump

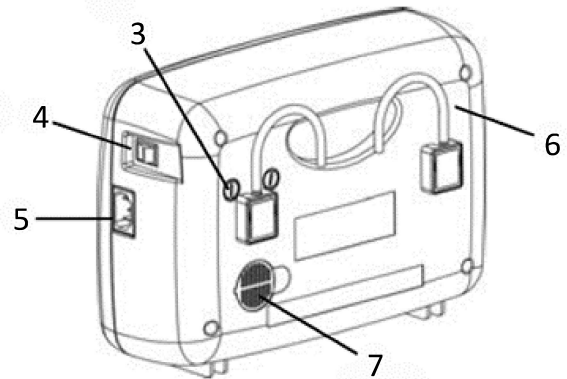
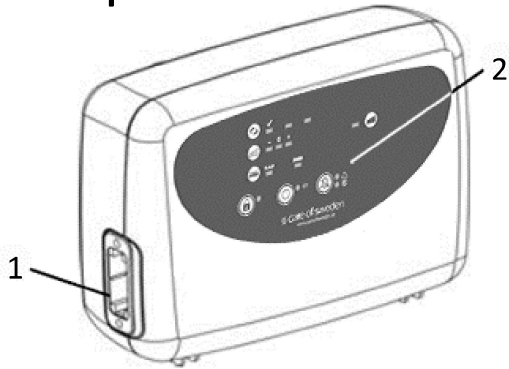

- 1. Tube connector
- 2. Control panel

- 3. Fuses (two)
- 4. Off/On (0/1)
- 5. Power cable connector

- 6. Bed hooks
- 7. Air filter

## 2.3 Pump functions – control panel

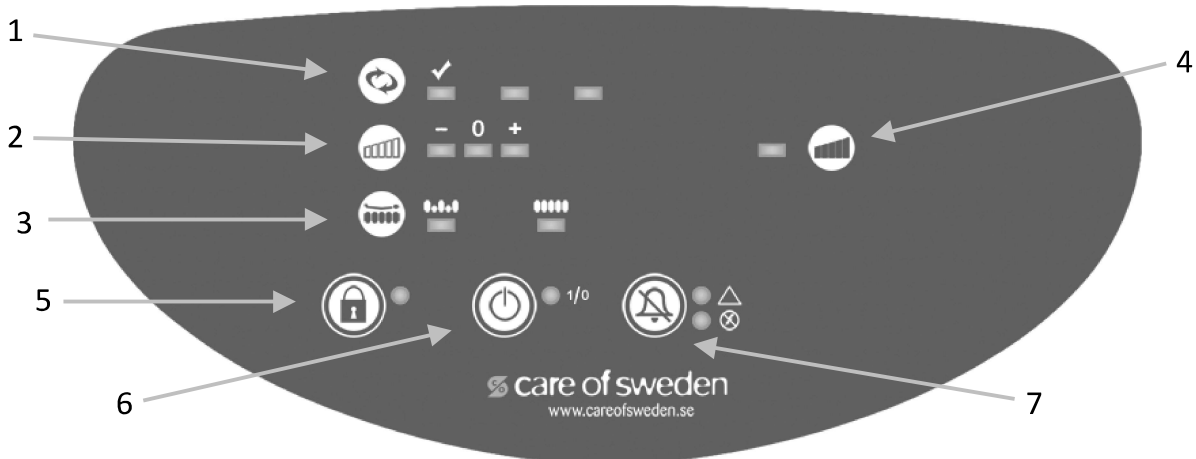

### 1. Automatic settings

This pump is equipped with a function that automatically sets the pressure based on the user's weight, posture and position. There are three ways to use this function.

1. The system adjusts the settings automatically when the system has been started.
2. Press the button and the system readjusts the automatic settings.

The system itself will start this function if any significant changes occur during use.

## Status lights

1. All three lights lit – Automatic settings adjustment under way.
2. Only the light under the checkmark (left) is lit – The mattress is ready to use, normal mode.
3. The light on the right is lit – The pump will automatically adjust its settings within five minutes.

Once the settings have been automatically adjusted, the system will revert to the previously used programme. However, when started it will switch to Alternating mode by default.

To stop the automatic setting adjustments, press the  button.

## 2. Comfort setting

The pressure can be increased or decreased one level depending on the user's comfort requirements.

## 3. Programmes

Two programmes are available. Press the button to switch between programmes.

1. Alternating mode. Here, the pressure alternates between the cells.
2. CLP mode. Here, the pressure will be same in all cells. This is also called "Constant low pressure".

## 4. Maximum pressure (caring mode)

With this function, the entire mattress is inflated and provides firm support. This function automatically reverts to the previous setting after about 30 minutes. NOTE: The automatic settings are overridden when using this programme.

## 5. Panel lock

Press the Panel lock button to lock or unlock the panel. The green light is lit when the panel is locked. The panel locks automatically after five minutes of inactivity. This is to prevent the settings being changed inadvertently.

## 6. Power off/on

Turns the power to the control panel on or off. NOTE: Check that the power cable is properly connected and that the power switch on the side of the pump is in position 1 (on).

## 7. Notification off

In the event of problems with notifications, see section 8 for troubleshooting.

### A. Power supply notification

If the pump loses power an audible and visual notification is triggered. Turn off the notification by pressing the Notification off button.

### B. Low pressure notification

If the mattress pressure is too low an audible and visual notification is triggered. Turn off the notification by pressing the "Notification off" button. It is reactivated after about five minutes if the pressure has not returned to normal.



### 3. Assembly/Installation

When unpacking, check that no parts are damaged. If any damage is found, contact Care of Sweden or your local distributor before using the product.

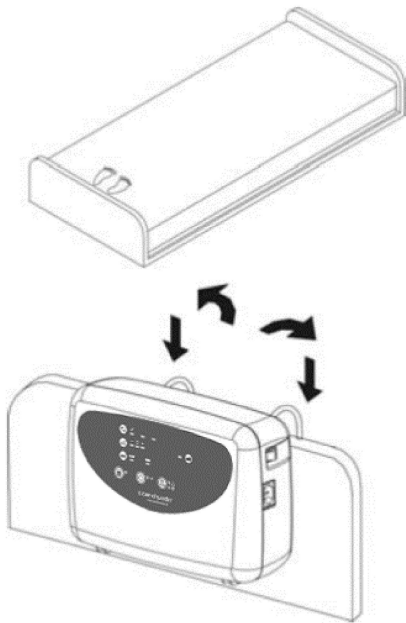

1. Place the mattress on the bed base. Secure the mattress to the bed using the straps on the underside of the mattress.

**Note:**

- Make the bed with a sheet to improve user comfort.
- Check that the CPR valve is closed.
- If an adjustable bed is used, the mattress should be secured only to the moving parts of the bed.
- Check the cells and press studs to ensure they are correctly assembled.

2. Hang the pump on the foot end of the bed or place the pump on a firm, level surface.

Place the power cable in the cable holder by opening the press studs, inserting the cable and closing the press studs.

If the cable holder is not used: Place the power cable so there is no risk of tripping over it, running over it with the bed wheels or pinching it when raising or lowering the bed.

**Note!** In order to minimize the risk of wounds occurring on the feet, make sure that the user doesn't come into contact with the hangers of the pump.

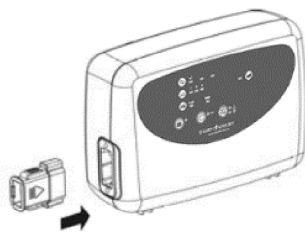

3. Connect the air tubes from the mattress to the side of the pump. A click is heard or felt when they are correctly connected.

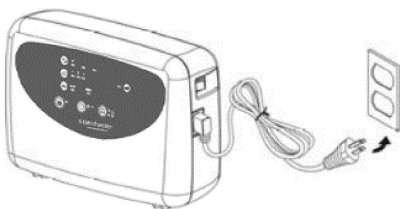

4. Check that the power switch on the side is set to 0 (off). Plug the power cable into an approved socket (220-240 V).



For 80/85/90x200/210



For 105/120x200/210

## 4. Operation



**Note:** Always read the instructions for use prior to use.

### 4.1 Start

1. Set the power switch on the side of the pump to 1 (on).
2. The mattress will start to inflate. It takes about 30 minutes to fully inflate the mattress.
3. You can start using the mattress when the top-left light is lit (only the light under the checkmark).



**NOTE:** Each time the systems starts up, it always begins by fully inflating the mattress and automatically adjusting the settings. See section 2.3 for more information. After automatically adjusting the settings, the system switches to Alternating mode by default.

If necessary, the user may lie down on the mattress immediately without it being inflated. The underlying mattress bears the weight during the inflation phase. If the underlying mattress is an air-filled type, it must be fully inflated.

### 4.2 Programme selection

Two different programmes are available, Alternating mode and CLP mode. See section 2.3 for detailed information. We recommend Alternating mode as the default setting.

There is another programme called Maximum Pressure.  This function is used in conjunction with nursing duties, changing the user's position and getting the user in or out of the bed.

### 4.3 Comfort setting, fine-tuning

The air pressure in the mattress can be adjusted up to three levels.

**NOTE:** When only parts of the mattress are under load, such as in the case of amputees, it may be necessary to raise the setting using the comfort setting.

### 4.4 Hand check (function control)

The hand check is used to ensure that the mattress is working properly.

This must be performed regularly; we recommend once per shift.

Place a hand between the cells under the user's pelvic region. Check that the user doesn't "bottom out" and rest on the underlying mattress. We recommend a margin of one or two fingers.

If the margin is too small, initiate automatic settings adjustment. Wait ten minutes and perform a new hand check.



## 4.5 CPR

In case of an emergency where CPR (cardiopulmonary resuscitation) is necessary: Quickly pull the CPR strap then loosen the quick connectors on the side of the pump for the fastest possible deflation.

### NOTE:

Make sure that the CPR strap is properly secured after use.



## 4.6 Notifications

In the event of unusually low air pressure in the mattress, the light for the low pressure notification lights and a buzzer sounds. See section 8 for troubleshooting.

Deactivate the notification by pressing the “Notification off” button on the pump control panel. If the problem is not resolved within about five minutes the notification will be reactivated.

The pump is also equipped with a power supply notification. If the pump loses power an audible and visual notification is triggered. Turn off the notification by pressing the “Notification off” button.

### **WARNING!**

If the air pressure remains low, search for damage to the mattress and the tubes. Repair when required or contact Care of Sweden or your local distributor.

## 4.7 Transport function

If the user needs to be moved in the bed the tubes can be connected together (detached from the pump). The mattress is put in constant low pressure and is in so-called transport mode.

We recommend using this function for short periods only.

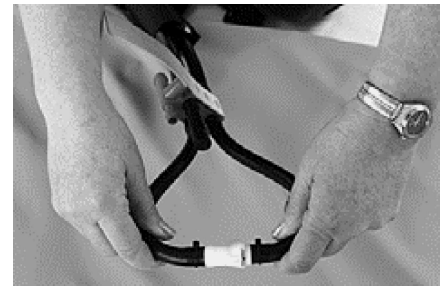

## 4.8 Heel function

The mattress has built-in heel relief. The last six cells at the foot end are designed to relieve sensitive heels.

## 5. Reuse, cleaning and reconditioning

The product is reusable. When reusing, it is important to follow the instructions below for cleaning and reconditioning. Before using the product again for a new user, it is recommended to clean the mattress in accordance with the instructions below. Consult your hygiene manager or Care of Sweden for help and instructions if you are unsure.

Cleaning and reconditioning should otherwise be performed as required.

### 5.1 Cleaning

#### PUMP



Wipe off the pump with a damp cloth and mild cleaning solution for this purpose: such as alcohol with or without tenside surfactants, oxidizing solutions, chlorine max 1 % or hydrogen peroxide max 1,5 %.

If using a different agent, choose one that does not affect the pump.

#### MATTRESS COVER



Covers can be wiped off with a mild cleaning solution for this purpose such as: alcohol with or without tenside surfactants, Isopropanol 70 %, oxidizing solutions, chlorine max 1 % (max 10% for cover Stone) or hydrogen peroxide max 1,5 %.

Excrement and blood stains must be removed as soon as possible using cold water. Carefully follow local instructions and the instructions for the detergent.



Multi-layer covers should be divided before washing. The parts should be washed with similar colours.



Chlorine and phenol-based cleaners could adversely affect the PU surface and should be avoided. If chlorine is used, we recommend a mixture of max 1 % (max 10% for cover Stone).

#### INNER COVER



Clean the affected area with a mild cleaning solution for this purpose such as: alcohol with or without tenside surfactants, Isopropanol 70 %, oxidizing solutions, chlorine max 1 % or hydrogen peroxide max 1,5 %.

## 5.2 Reconditioning

### PUMP

See section 5.1 for instructions.

### MATTRESS

1. Disconnect the tube connector from the pump and remove the air from the mattress.
2. Remove the covers. For more information of cleaning the covers, see section 5.1.
3. Move the mattress to a clean area that is suitable for cleaning.
4. Wipe off the cells, all tubes and the CPR module with a mild cleaning solution for this purpose such as: alcohol with or without tenside surfactants, Isopropanol 70 %, oxidizing solutions, chlorine max 1 % or hydrogen peroxide max 1,5 %. Let it dry.
5. Wipe off the work surfaces using a suitable detergent and/ or disinfectant.
6. Put the mattress together. If cells for any reason have become loose from the tubes, these must be replaced according to the drawing in section 2.1.

### FOAM CORE

Clean the affected area with a mild detergent (such as washing-up liquid) and water or with an alcohol-based disinfectant /cleaner intended for this purpose. Gently squeeze out any water.

#### **NOTE:**

Check the hygiene cover, cells and hoses each time the product is cleaned. If damaged, it must be replaced or repaired. Also check the pump, tube connectors and power cable during cleaning. Damaged parts must be replaced or repaired.

Do not wring or roll the foam core to extract the water. Let it dry in a warm, ventilated area (not in direct sunlight). The foam core must be completely dry before it is used again.

## 6. Storage

It is advisable to store the mattress and pump in the product bag (accessory). Handle the stored product with care. Do not place any heavy objects on top of it.

## 7. Maintenance

### 7.1 General

1. Check the power cable and plug for damage and scratches.
2. Check the mattress protection to make sure it is undamaged and that covers and cells are correctly assembled.
3. Check that the air flow alternates between the different outputs on the side of the pump.
4. Check that no tubes or connectors are damaged or pinched. Contact Care of Sweden or your local distributor if any spare parts are required.

### 7.2 Changing fuses

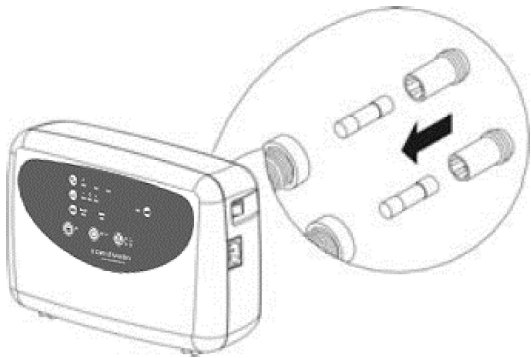

1. Remove the plug from the wall socket when replacing fuses.
2. Use a screwdriver to remove the fuse cover. Pull out the fuse holder.
3. Insert a new fuse of the same type (T1A/250V) and screw the protective cover back into place. There are two fuses.

### 7.3 Changing the air filter

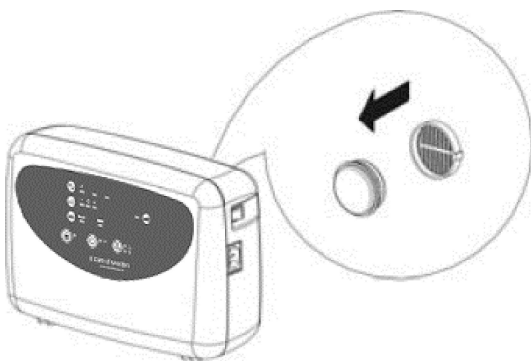

1. Loosen the small, round protective plate on the back of the pump.
2. Remove the filter from the holder.
3. Insert the new filter in the holder and replace the protective plate.

If the pump is used in a very dirty environment, the filter should be checked regularly.

## 8. Troubleshooting

Problem	Solution
Pump does not start	Check that the power cable is connected to a socket. Check the fuses.
Notification triggered = mattress losing air	Check that the quick connectors for the tubes on the side of the pump are properly connected. Check that the CPR valve is closed. Open the mattress and check for any leaks from air cells or tubes. Check that all tube connectors are fine and properly connected.
User bottoms out	Check the mattress in accordance with “Notification triggered” above. See sections 4.3 and 4.4 for more.
Mattress not stationary	Check that the mattress is secured to the bed base with the straps underneath (two at the head end and two on each of the long sides).
Some cells less inflated	This is normal if the Alternating mode is selected as the air supply alternates between cells every cycle (one cycle = ten minutes).
Noisy pump, vibrations can be felt	Check that the pump is correctly attached to the bed. Resonance may occur in parts of the bed. Remove the pump and listen to see whether there’s any difference. This can be resolved by placing the pump on a level surface. Or by putting, for instance, a towel between the pump and the bed.
If your questions are not answered by the above information, please contact Care of Sweden or your local distributor.	

## 9. Technical description

### 9.1 Technical specification

PUMP		SPECIFICATION
Model		CuroCell® AUTO420
Voltage		220V-240 V, 50-60 Hz
Current		0.07 A
Fuse type		T1A/250V
Cycle		10 min
Dimensions (LxWxH)		29.1 x 20 x 11.7 cm
Weight		2.2 kg
Ambient environment	Temperature	Operation: 10°C - 40°C
		Storage: -15°C -50°C
		Shipping: -15°C -70°C
	Humidity	Operation: 10% - 90% non-condensing
		Storage: 10% - 90% non-condensing
	Atmospheric pressure (or air pressure)	700 hPa-1060 hPa
Classification		Class II, Type BF, IP41
MATTRESS		SPECIFICATION
Model		CuroCell® AUTO420
Dimensions (WxLxH)		80/85/90/105/120x200/210x20 cm
Weight		11 kg (80x200 cm)

**NB:** Care of Sweden reserves the right to modify the product specification at any time.

#### **WARNING!**

Follow the operation and maintenance instructions carefully in order to prevent physical injury, as well as damage to the product or other equipment.

### 9.2 Standards

The system is tested and approved according to the following European standards where applicable requirements are met.

IEC 60601-1	EN ISO 10993	ISO 3746
IEC 60601-1-2	EN 12182	ISO 11201
IEC 60601-1-11	EN597-1	
IEC 60601-1-6	EN 597-2	
IEC 62304	EN ISO 14971	

### 9.3 Labelling

Labels on the mattress include product name, item number, date of manufacture, size, EAN number and care and washing instructions. The mattress also has labels for the top and bottom and head and foot ends, as well as space for your own marking (such as ward number and name).



## 9.4 Symbol key



Item number



Manufacturer

XXXX-XX-XX

Year-Month-Day



Foot placement



Read the instructions for use



Function group



CE-marked in accordance with Medical Device Regulation (EU) 2017/745



Recycling



Do not dispose of with household waste; follow recycling instructions



Recommended user weight

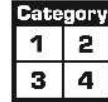

User information – category



Placed directly on the bed base



Counteracts shearing



Heel function



Do not machine



Machine wash at 70°C

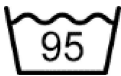

Machine wash at 95°C



Chlorine



Tumble dry



Do not tumble dry



Drip dry



Do not iron



Do not dry clean



Wipe clean



Class II equipment (Double-insulated)



Type BF



IP code (ingress protection rating)



Temperature range

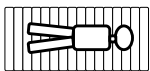

The mattress should be used with the user lying in the lengthwise direction



Distributed by



Medical Device



UDI

## 10. Spare parts

<b>Item no.</b>	<b>Description</b>	<b>Size</b>
CC-906010	Top part Olivia, grey	80x200 cm
CC-906011	Top part Olivia, grey	80x210 cm
CC-906012	Top part Olivia, grey	85x200 cm
CC-906013	Top part Olivia, grey	85x210 cm
CC-906014	Top part Olivia, grey	90x200 cm
CC-906015	Top part Olivia, grey	90x210 cm
CC-906016	Top part Olivia, grey	105x200 cm
CC-906017	Top part Olivia, grey	105x210 cm
CC-906018	Top part Olivia, grey	120x200 cm
CC-906019	Top part Olivia, grey	120x210 cm
CC-905610	Bottom part CuroCell, black	80x200 cm
CC-905611	Bottom part CuroCell, black	80x210 cm
CC-905612	Bottom part CuroCell, black	85x200 cm
CC-905613	Bottom part CuroCell, black	85x210 cm
CC-905614	Bottom part CuroCell, black	90x200 cm
CC-905615	Bottom part CuroCell, black	90x210 cm
CC-905616	Bottom part CuroCell, black	105x200 cm
CC-905617	Bottom part CuroCell, black	105x210 cm
CC-905618	Bottom part CuroCell, black	120x200 cm
CC-905620	Bottom part CuroCell, black	120x210 cm
CC-901410-K	Head cell, PU	80x15 cm
CC-901412-K	Head cell, PU	85x15 cm
CC-901414-K	Head cell, PU	90x15 cm
CC-901416-K	Head cell, PU	105x15 cm
CC-901418-K	Head cell, PU	120x15 cm
CC-901420-K	Heel cell, PU	80x13 cm
CC-901422-K	Heel cell, PU	85x13 cm
CC-901424-K	Heel cell, PU	90x13 cm
CC-901426-K	Heel cell, PU	105x13 cm
CC-901428-K	Heel cell, PU	120x13 cm
CC-901514-K	Safety cell, PU (for mattress width 80 cm)	75x60 cm
CC-901512-K	Safety cell, PU (for mattress width 85 cm)	80x60 cm
CC-901510-K	Safety cell, PU (for mattress width 90 cm)	85x60 cm
CC-901516-K	Safety cell, PU (for mattress width 105 cm)	100x60 cm
CC-901518-K	Safety cell, PU (for mattress width 120 cm)	115x60 cm
CC-901524-K	Safety cell, PU (for mattress width 80 cm)	75x80 cm
CC-901522-K	Safety cell, PU (for mattress width 85 cm)	80x80 cm
CC-901520-K	Safety cell, PU (for mattress width 90 cm)	85x80 cm
CC-901526-K	Safety cell, PU (for mattress width 105 cm)	100x80 cm
CC-901528-K	Safety cell, PU (for mattress width 120 cm)	115x80 cm

CC-901544-K Safety cell, PU (for mattress width 80 cm)	75x70 cm
CC-901542-K Safety cell, PU (for mattress width 85 cm)	80x70 cm
CC-901540-K Safety cell, PU (for mattress width 90 cm)	85x70 cm
CC-901546-K Safety cell, PU (for mattress width 105 cm)	100x70 cm
CC-901548-K Safety cell, PU (for mattress width 120 cm)	115x70 cm
CC-400905 Pump for mattress width 80, 85, 90 cm	
CC-400906 Pump for mattress width 105, 120 cm	
CC-8217 Fuse (2-pack)	-

If other spare parts are required, please contact Care of Sweden or your local distributor.

## 11. Options and accessories

### 11.1 Options

#### Sheet holder

Helps keep the sheet in place. A clip for attaching to the cover; six per mattress.

### 11.2 Accessories

Sturdy transport bag		Sheet holder, each	
<b>Item no.</b>	<b>Size</b>	<b>Item no.</b>	<b>Size</b>
CC-9094	80-90 cm	CC-9075	-
CC-9095	105-120 cm		

Top part LF (low friction) - Top part with increased sliding function, can be used for heavy immobile users.

### 11.3 Other accessories

To ensure the best level of comfort, we recommend the use of accessories from Care of Sweden since our products are designed to work well together. If you require any accessories, or for more information about our products, please contact Care of Sweden or your local distributor. You can also visit our website – [www.careofsweden.com](http://www.careofsweden.com).

## **12. Warranty**

### **12.1 Scope**

This CuroCell® system is covered by a 2-year warranty for manufacturing defects. The warranty does not apply to normal wear and tear or damage due to negligence or improper handling/care.

### **12.2 Service and maintenance**

The CuroCell® alternating pressure mattress is a medical device, in accordance with Medical Device Regulation (EU) 2017/745, that is used to prevent and help treat pressure ulcers/pressure injuries. For this reason, we recommend that the pump is regularly serviced and inspected to maintain functionality and performance. Like other technical devices, a pump that is properly cared for works better and lasts longer.

Service and maintenance must always be performed by Care of Sweden or one of its authorised service providers. Only use spare parts that have been approved by Care of Sweden. The use of non-approved spare parts invalidates the warranty.

Faults and defects regarded as warranty faults are rectified free of charge.

A warranty claim must be submitted to Care of Sweden before the product is returned.

### **12.3 Life expectancy**

This product's expected life is estimated to be 5 years.

## 13. Other information

### 13.1 Disassembly and recycling

Except for certain parts of the pumps, energy recovery is possible for almost all material in CuroCell® products through incineration at waste incineration facilities.

**Pump:**

A used CuroCell® pump must not be disassembled. Instead it should be taken to a recycling centre. The product is sorted as “electronic waste”.

**Mattress:**

A used CuroCell® mattress must be taken to a recycling centre. The product is sorted as “combustible waste”. Care of Sweden complies with its manufacturer responsibility through its affiliation with the REPA register and El-kretsen AB. For more information, please contact Care of Sweden or your local distributor.

### 13.2 Returns and warranty claims

Contact Care of Sweden **before** returning the product. The return postage will be paid by Care of Sweden if the fault is covered by the product warranty, otherwise by the customer.

## 14. Notes

---

---

---

---

---

---

---

---

---

---

---

---

---

---

---

---

---

---

---

---

---

---

---

---

---

---

---

---

---

---

---

---

---

---

---

---

---

---

---

---

---

---

---

---

---

---



Manufactured by

 care of sweden

**SUPPORTING LIFE**

**Contact:**

Telephone: +46 (0)771-106 600

Fax: +46 (0)325-128 40

E-mail: [export@careofsweden.se](mailto:export@careofsweden.se)

Internet: [www.careofsweden.com](http://www.careofsweden.com)

**Postal address:**

Care of Sweden AB  
Box 146  
SE-514 23 Tranemo  
SWEDEN

**Visiting address:**

Fabriksgatan 5A  
SE-514 33 Tranemo  
SWEDEN

**Deliveries address:**

Byns väg 4A  
SE-514 33 Tranemo  
SWEDEN